

# A-LE212

Lavabo

## DESCRIPCIÓN

Grifo para lavabo autoportante de 1199,7 mm. de altura para montaje a suelo. Combinable con mezclador monomando modelo 1 o 2.

Fabricado en latón.

## COMPONENTES

- Parte interna del grifo: A-LE212-UP.

## CAUDAL

3.0 bar

22 l/min

## ACABADOS DISPONIBLES



Cromo



Negro mate

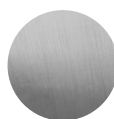
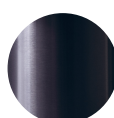

Blanco mate

Níquel  
cepilladoCobre  
cepilladoOro  
cepillado

Gunmetal

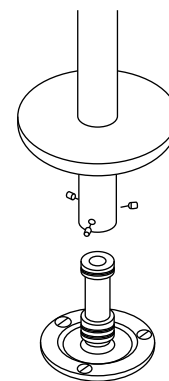
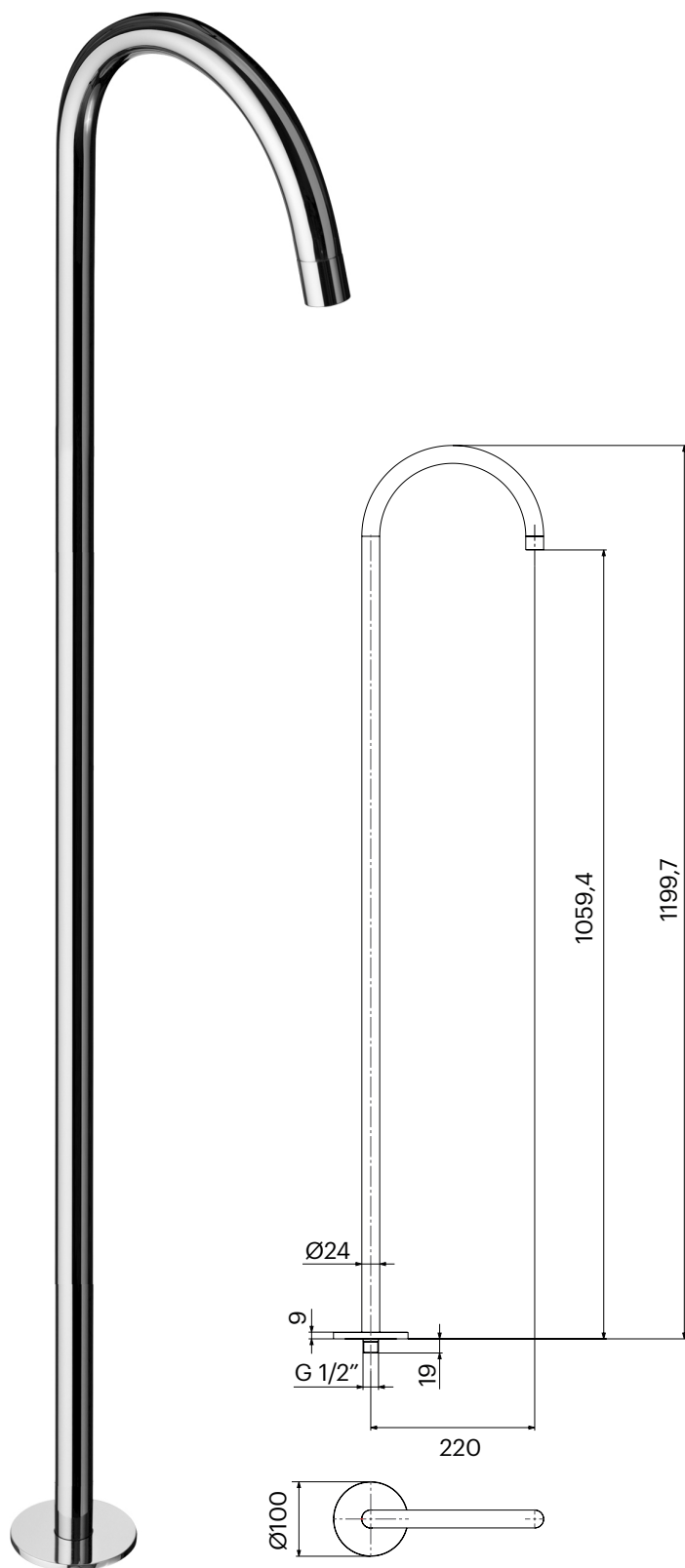

Base para fijación a suelo.

Dimensiones en mm.

Made in EU

# A-LE212

Basin

## DESCRIPTION

Floor-mounted freestanding basin tap, 1199.7 mm high. Can be combined with model 1 or 2 single-lever mixer.

Made of brass.

## COMPONENTES

- Internal part of the faucet: A-LE212-UP.

## FLOW RATE

3.0 bar      22 l/min

## AVAILABLE FINISHES



Chrome

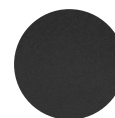

Matt black

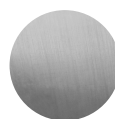
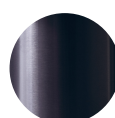

Matt white

Brushed  
nickelBrushed  
copperBrushed  
gold

Gunmetal

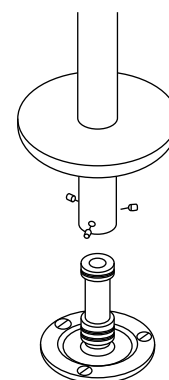
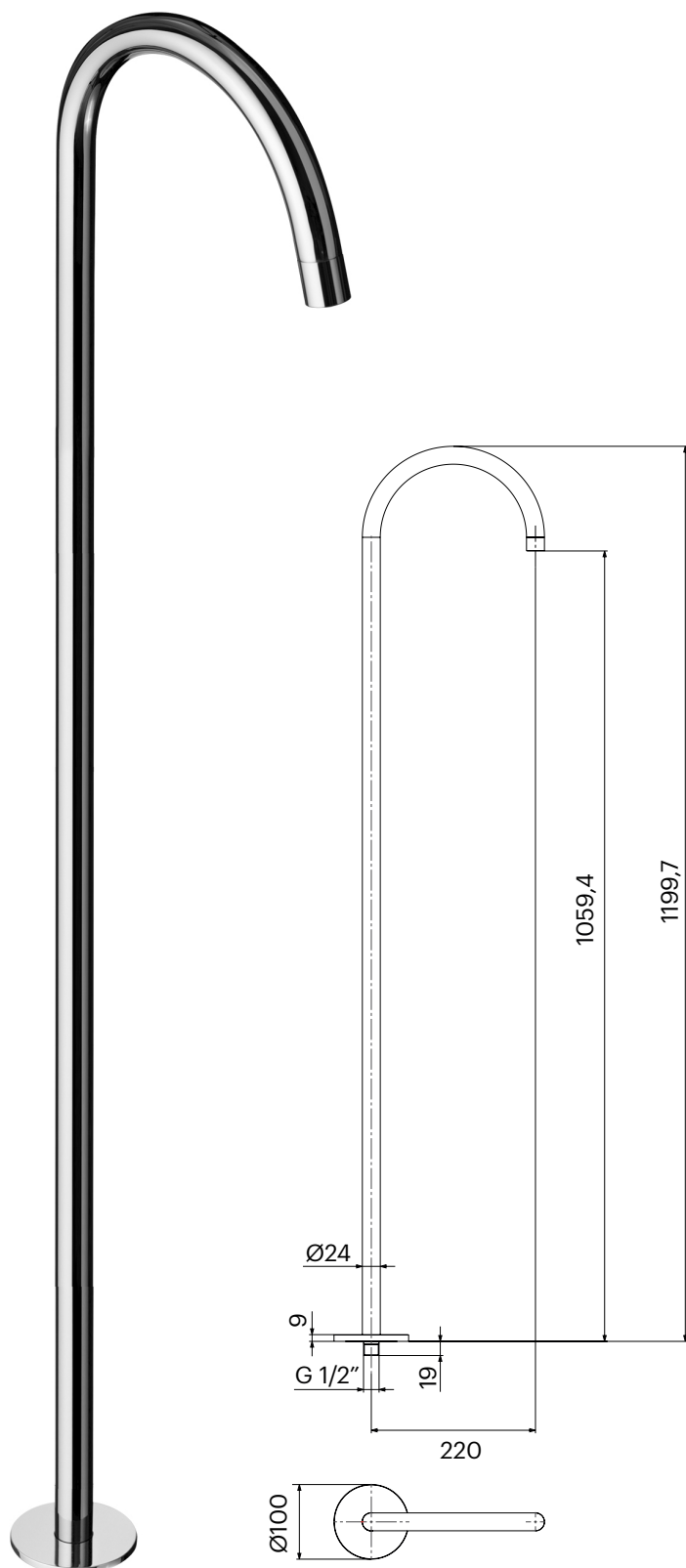

Base for floor mounting.

Dimensions in mm.

Made in EU

# A-LE212

Lave-mains

## DESCRIPTION

Mitigeur à poser au sol pour vasque, 1199,7 mm de hauteur. Peut être combiné avec le mitigeur modèle 1 ou 2.

Fabriqué en laiton.

## COMPONENTES

- Partie interne du robinet: A-LE212-UP.

## DÉBITS

3.0 bar

22 l/min

## FINITIONS DISPONIBLES



Chrome

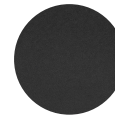

Noir mat



Blanc mat

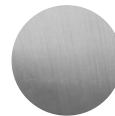

Nickel  
brossé



Cuivre  
brossé



Or  
brossé

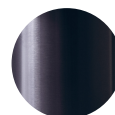

Canon  
fusil

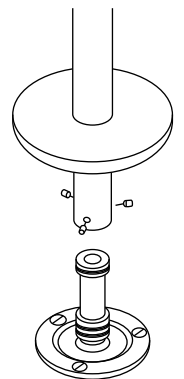
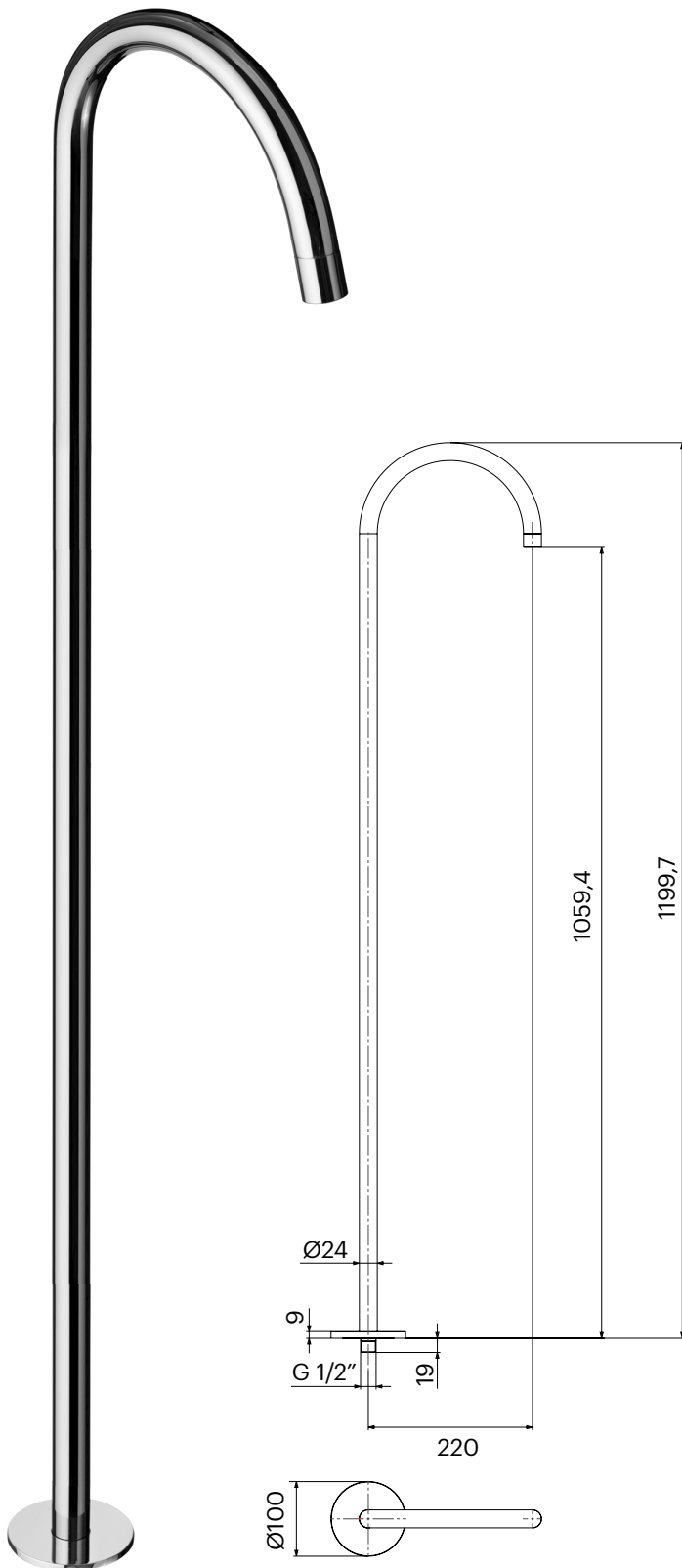

Base pour fixation au sol.

Dimensions en mm.

Made in EU