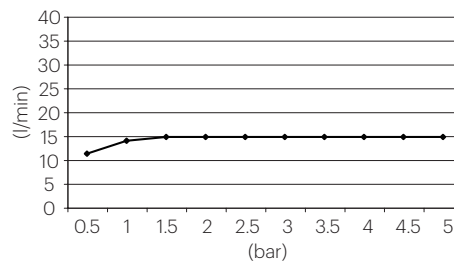

**DESCRIPCIÓN**

Rociador rectangular de 236x21 mm de pared.  
Caída del agua modo cascada.

Fabricado en acero inoxidable AISI 304 o AISI 316.

**CAUDALES****DISPONIBLES REDUCTORES DE CAUDAL****BREEAM®**

9 l/m - C069019

6,6 l/m - C069060

AG 1 CONSUMO DE AGUA - REDUCTORES DE CAUDAL Y AIREADORES.  
Nota técnica NT17.

**ACABADOS DISPONIBLES****Acero inoxidable AISI 304**

Negro  
mate



Blanco  
mate



Acero inox.  
brillante



Oro  
brillante

**Acero inoxidable AISI 316**

Acero inox.  
cepillado



Gunmetal



Cobre  
cepillado



Oro  
cepillado

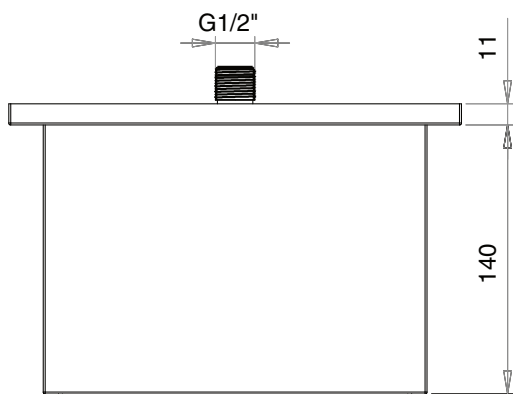
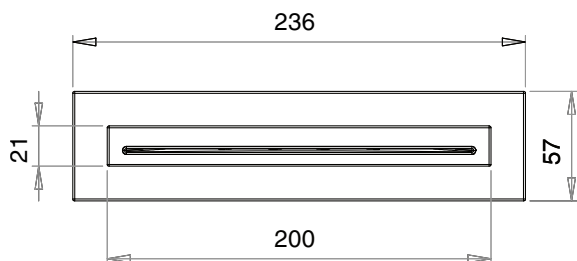

# D-CP

Shower heads



## DESCRIPTION

Wall-mounted rectangular shower head of 236x21 mm. Water falls in cascade mode.

Made of stainless steel AISI 304 or AISI 316.

## FLOW RATES

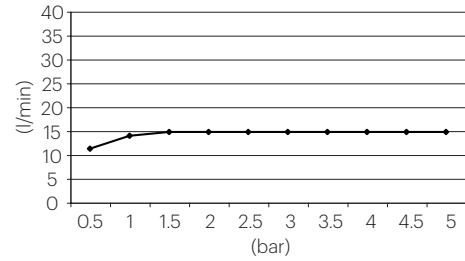

## FLOW REDUCERS AVAILABLE

BREEAM®

9 l/m - C069019

6,6 l/m - C069060

AG 1 WATER CONSUMPTION - REDUCERS FLOW AND AERATORS.  
Tech Note NT17.

## AVAILABLE FINISHES

### Stainless steel AISI 304



Matt black



Matt white



Polished stainless steel



Polished gold

### Stainless steel AISI 316



Brushed stainless steel



Gunmetal



Brushed copper



Brushed gold

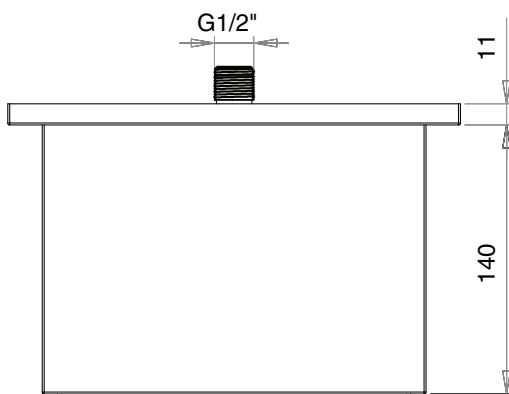
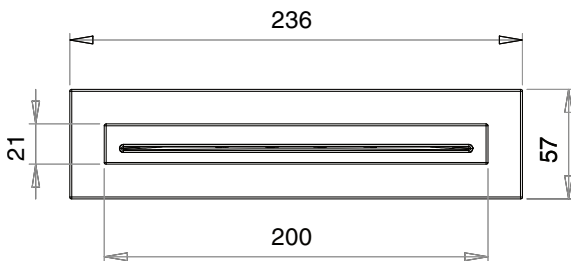

# D-CP

Pommeaux de douche



## DESCRIPTION

Douche rectangulaire type cascade 236x21 mm.  
Chute d'eau en mode cascade.

Fabriquée en acier inoxydable AISI 304 ou AISI 316.

## DÉBITS

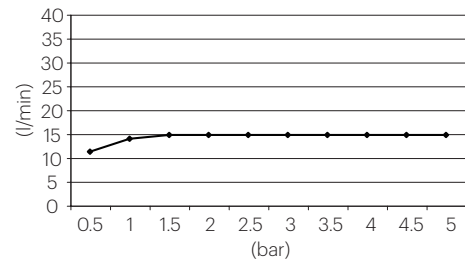

## RÉDUCTEURS DE DÉBIT DISPONIBLES

BREEAM®

9 l/m - C069019

6,6 l/m - C069060

AG | CONSOMMATION D'EAU - RÉDUCTEUR DE DÉBIT ET AÉRATEURS.  
Note technique NT17.

## FINITIONS DISPONIBLES

### Acier inoxydable AISI 304

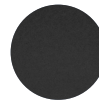

Noir  
mat



Blanc  
mat



Acier inox.  
brillant



Or  
brillant

### Acier inoxydable AISI 316



Acier inox.  
brossé

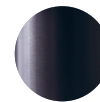

Gunmetal



Cuivre  
brossé



Or  
brossé

