

D-R250

Rociadores

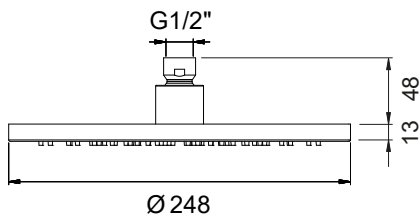

POSICIÓN DEL REDUCTOR

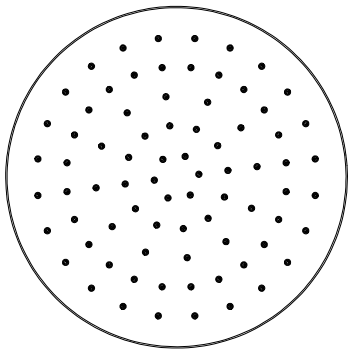
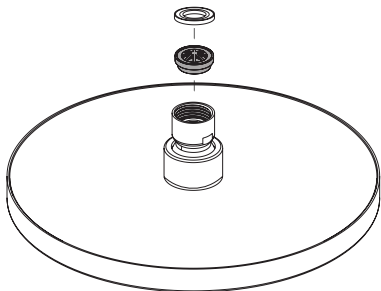

El reductor va ubicado en el interior del cabezal

Made in EU

DESCRIPCIÓN

Rociador de ducha circular de 250x250 mm.

- Instalación a pared o a techo.
- Caída del agua modo lluvia.
- Con rótula orientable hasta 30°.

Fabricado en latón, acero inoxidable 304 o 316.

CAUDALES

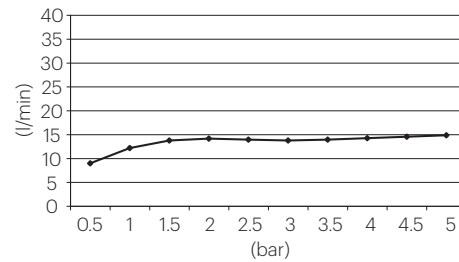

DISPONIBLES REDUCTORES DE CAUDAL

BREEAM®

6,6 l/m - C069060

9 l/m - C069019

AG 1 CONSUMO DE AGUA - REDUCTORES DE CAUDAL Y AIREADORES.
Nota técnica NT17.

ACABADOS DISPONIBLES

Latón



Cromo

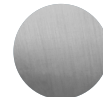

Níquel cepillado



Negro mate



Blanco mate

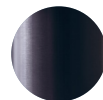

Gunmetal



Cobre cepillado



Oro brillante



Oro cepillado

Acero inoxidable AISI 304



Acero inox.
brillante

Acero inoxidable AISI 316



Acero inox.
cepillado

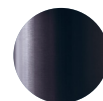

Gunmetal



Cobre cepillado



Oro cepillado

CERTIFICACIONES



D-R250

Shower heads

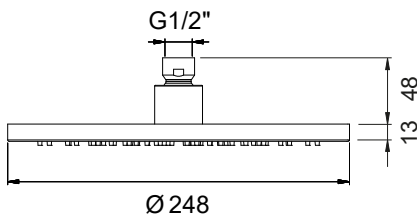
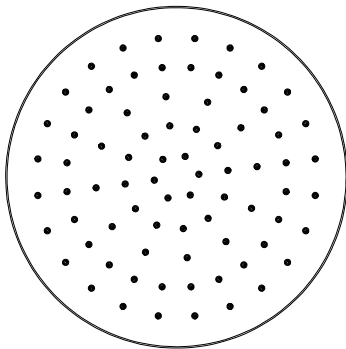

REDUCTOR POSITION

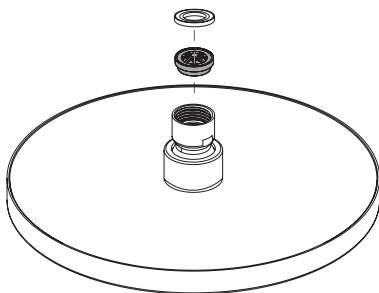

The reducer is located inside the shower head

Made in EU

DESCRIPTION

- Circular shower head of 250x250 mm.
- Wall or ceiling installation.
- Water fall rain mode.
- 30° steerable swivel ball.

Made of brass, 304 or 316 stainless steel.

FLOW RATES

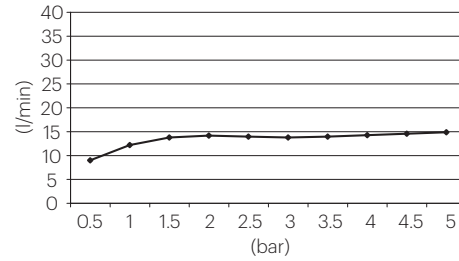

FLOW REDUCERS AVAILABLE

BREEM®

6,6 l/m - C069060

9 l/m - C069019

AG 1 WATER CONSUMPTION - REDUCERS FLOW AND AERATORS.
Tech Note NT17.

FINISHES AVAILABLE

Brass



Stainless steel AISI 304



Stainless steel AISI 316

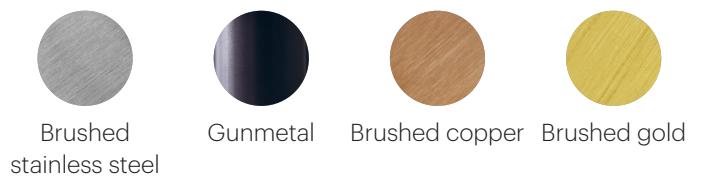

CERTIFICATIONS



D-R250

Pommeaux de douche

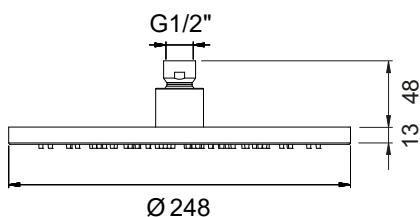
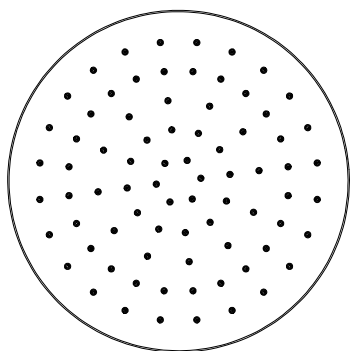

EMPLACEMENT RÉDUCTEUR

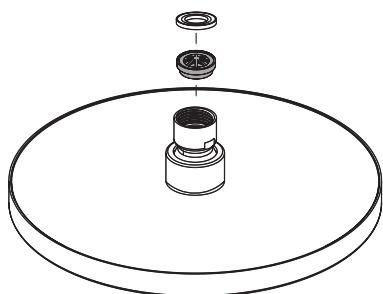

Le réducteur est situé à l'intérieur de la pomme de douche

Made in EU

DESCRIPTION

- Pomme de douche ronde de 250x250 mm.
- Installation au mur ou au plafond.
- Chute d'eau en mode pluie.
- Pivotante à 30°.

Fabriquée en laiton, acier inoxydable 304 ou 316.

DÉBITS

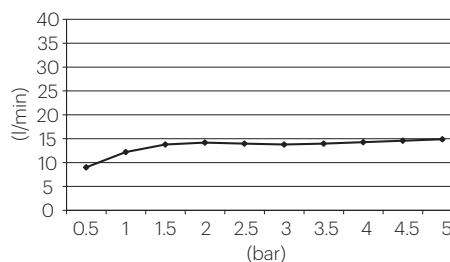

RÉDUCTEURS DE DÉBIT DISPONIBLES

BREEM®

6,6 l/m - C069060

9 l/m - C069019

AG | CONSOMMATION D'EAU - RÉDUCTEUR DE DÉBIT ET AÉRATEURS.
Note technique NT17.

FINITIONS DISPONIBLES

Laiton



Chrome

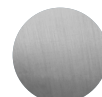

Nickel brossé



Noir mat



Blanc mat



Canon fusil



Cuivre brossé



Or brillant



Or brossé

Acier inoxydable AISI 304



Acier inox.
brillant

Acier inoxydable AISI 316



Acier inox.
brossé



Gunmetal



Cuivre brossé



Or brossé

CERTIFICATIONS

