

H3060M1

Hornacinas



DESCRIPCIÓN

Hornacina con marco de 325x625 mm con 1 estante*, trasera del mismo color que el conjunto e instalación horizontal o vertical.

*Posición a concretar por el cliente, por defecto centrado.
Iluminación interior no disponible.

CARACTERÍSTICAS

- Fabricada en Solid Surface.

Dimensiones 325x625x89 mm
 Grosor Marco 6 mm
 Grosor estante 8 mm

ACABADOS DISPONIBLES



Blanco
mate

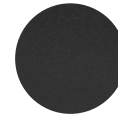

Negro
mate



Color
RAL

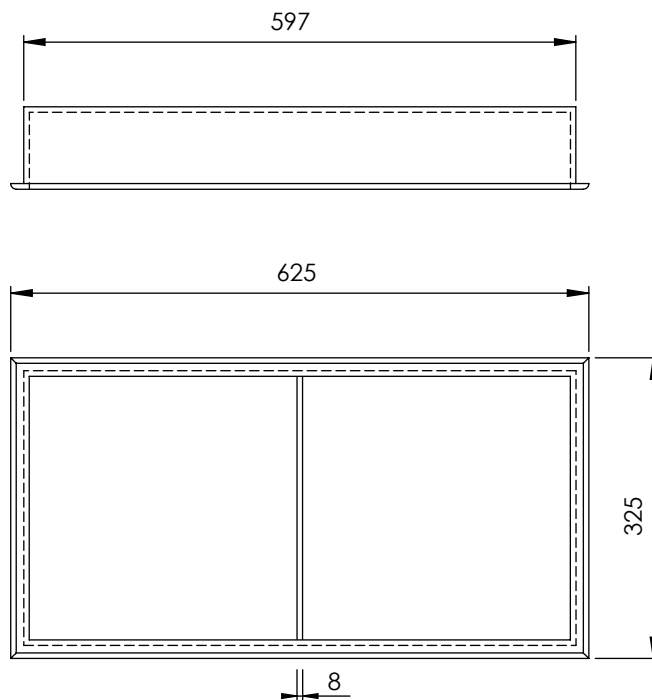

Dimensiones en mm.

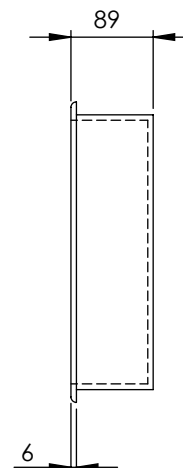

SANITARY

H3060M1

Niche

ES | EN | FR

www.iconico.es
hola@iconico.es



DESCRIPTION

Framed 325x625 mm niche with 1 shelf*, with back in the same colour of the assembly and horizontal or vertical installation.

*Position must be specified by the customer, by default centred.
Interior lighting not available.

FEATURES

- Made of Solid Surface.

Dimensions 325x625x89 mm
Frame thickness 6 mm
Shelf thickness 8 mm

AVAILABLE FINISHES



Matt
white

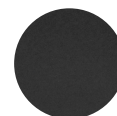

Black
matt



RAL
Colour

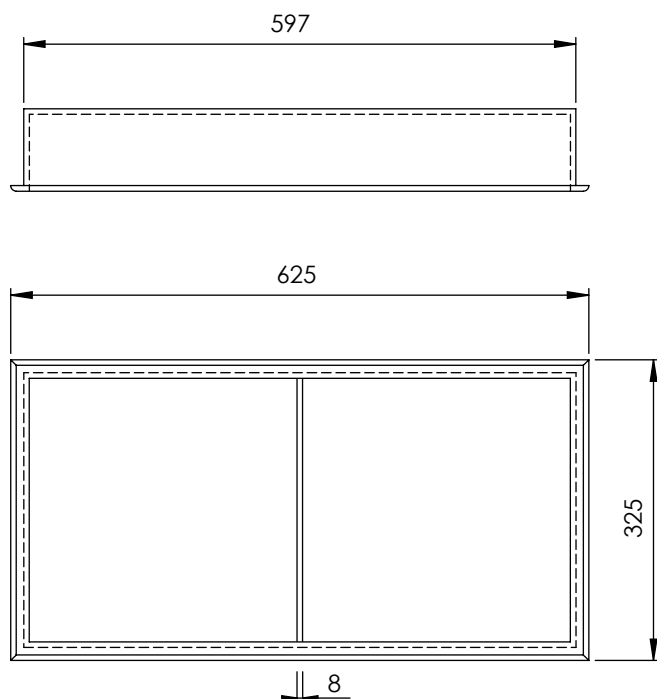

Dimensions in mm.

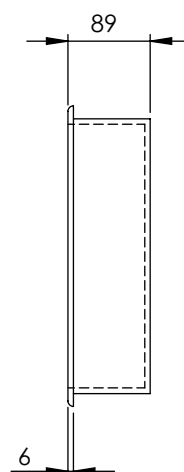

Made in EU

ICÓNICO
Elements for architecture

SANITAIRE

H3060M1

Niche encastrable

ES | EN | FR

www.iconico.es
hola@iconico.es



DESCRIPTION

Niche avec cadre de 325x625 mm avec 1 étagère*, avec le fond dans la même couleur que l'ensemble et installation horizontale ou verticale.

*Position à spécifier par le client, centrée par défaut.
L'éclairage intérieur n'est pas disponible.

CARACTÉRISTIQUES

- Fabriqué en Solid Surface.

Dimensions	325x625x89 mm
Épaisseur du cadre	6 mm
Épaisseur de l'étagère	8 mm

FINITIONS DISPONIBLES



Blanc
mat

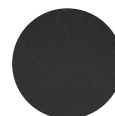

Noir
mat



Couleur
RAL

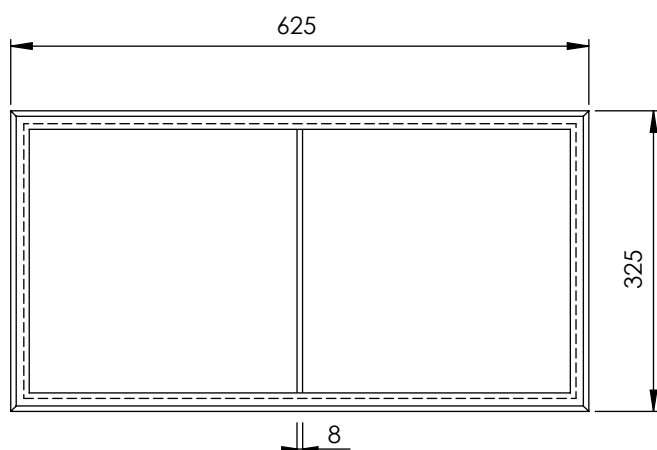
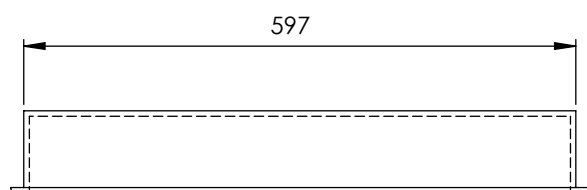

Dimensions en mm.

